

100  
0 10  
A1

DO NOT SCALE

File: CP1770-BLP-ZZ-ZZ-M2-MA-0007-00 Conservation Designations Existing.dwg  
Date: Jul 05, 2019 - 1:32pm Plotted by: TJOConnell

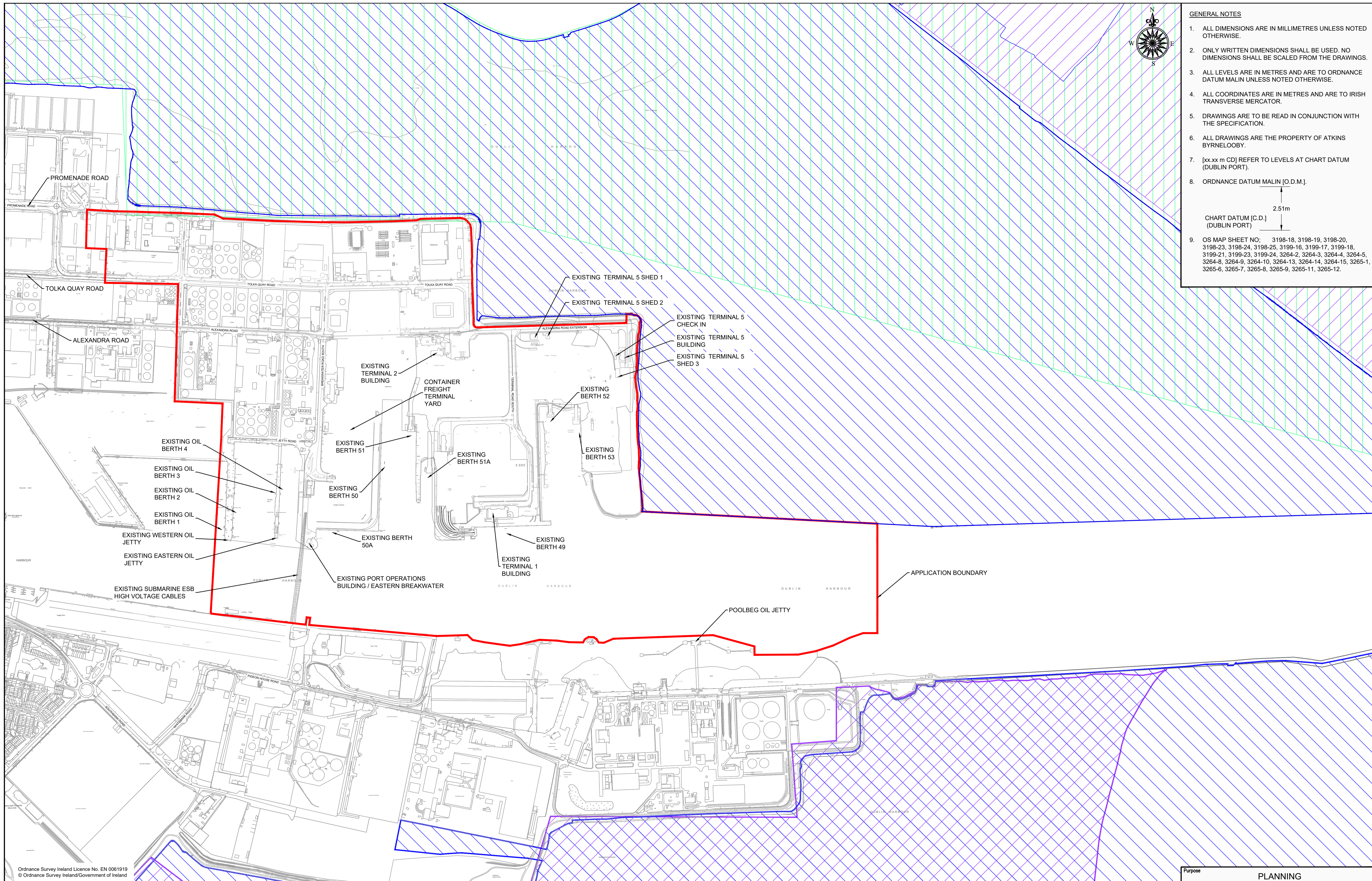

- GENERAL NOTES**
1. ALL DIMENSIONS ARE IN MILLIMETRES UNLESS NOTED OTHERWISE.
  2. ONLY WRITTEN DIMENSIONS SHALL BE USED. NO DIMENSIONS SHALL BE SCALED FROM THE DRAWINGS.
  3. ALL LEVELS ARE IN METRES AND ARE TO ORDNANCE DATUM MALIN UNLESS NOTED OTHERWISE.
  4. ALL COORDINATES ARE IN METRES AND ARE TO IRISH TRANSVERSE MERCATOR.
  5. DRAWINGS ARE TO BE READ IN CONJUNCTION WITH THE SPECIFICATION.
  6. ALL DRAWINGS ARE THE PROPERTY OF ATKINS BYRNELOOBY.
  7. [xx.xx m CD] REFER TO LEVELS AT CHART DATUM (DUBLIN PORT).
  8. ORDNANCE DATUM MALIN [O.D.M.]  
 CHART DATUM [C.D.] (DUBLIN PORT)  
 2.51m
  9. OS MAP SHEET NO: 3198-18, 3198-19, 3198-20, 3198-23, 3198-24, 3199-16, 3199-17, 3199-18, 3199-21, 3199-23, 3199-24, 3264-2, 3264-3, 3264-4, 3264-5, 3264-8, 3264-9, 3264-10, 3264-13, 3264-14, 3264-15, 3265-1, 3265-6, 3265-7, 3265-8, 3265-9, 3265-11, 3265-12.

Ordnance Survey Ireland Licence No. EN 0061919  
© Ordnance Survey Ireland/Government of Ireland

- APPLICATION BOUNDARY
- SOUTH DUBLIN BAY & RIVER TOLKA SPECIAL PROTECTION AREA (SPA) 004014
- SOUTH DUBLIN BAY SPECIAL AREA OF CONSERVATION (SAC) 000210
- SOUTH DUBLIN BAY PROPOSED NATURAL HERITAGE AREA (pNHA) 000210

Rev	Description	By	Date	Chk'd	Auth
00	ISSUED FOR PLANNING	TJOC	07.19	SMC	AC

**ATKINS**  
Member of the SNC-Lavalin Group

**BYRNELOOBY**  
WS Atkins Ireland Ltd. & ByrneLooby Partners Ltd.  
Atkins House,  
150 Airside Business Park,  
Swords, Co. Dublin

Client  
**COMHLACHT CHALAFOR  
ÁTHA CLIAH  
DUBLIN PORT COMPANY**

Project  
**MP2**

Purpose <b>PLANNING</b>	
Title <b>CONSERVATION DESIGNATIONS EXISTING SITE PLAN</b>	
Original Scale <b>1:5,000 @A1</b>	Design/Drawn TJOC
Date 17.06.19	Checked SMC
Date 17.06.19	Authorised AC
Status <b>P</b>	Drawing Number <b>CP1770-BLP-ZZ-ZZ-M2-MA-0007</b>
Rev <b>00</b>	